



Motorized



Retractable



New : our in-ceiling screen is now available Tense and Platinum

With manufacturing quality at the height of Lumene screens, this version 4K / 8K voltage is perfectly adapted to the latest projectors on the market. Repeating the same characteristics as its predecessor, this tensioned screen has a high quality 4K / 8K canvas. Its exclusive technology ensures a perfect image, a sharp contrast for one of the best rendering nowadays.

Note : a very slight phenomenon of luminous halo or moiré on texts (including subtitles) may form if the screen is positioned too close to the wall. This is due to the reverberation of the light on the wall behind the screen.



Built-in IR and RF control system



Tab tensioning system



In-ceiling



Home automation

SPECIFICATIONS

Screen material

High quality LUMENE screen material
Projection surface : Lumene UHD4K/8K Platinum canvas
Tensioned : oui
Black borders : non
Gain de 1,3
Directivité 150°
Treatments : anti-yellowing, anti-dust, anti curling

Case

Aluminium
In-ceiling mounting
Hook for hanging installation from ceiling

Motor

Lumene Silent Motor, reliable and silent

Control system

RS232 for home automation
Built in RS485, close contact
Remote control with fine adjustment system (batteries provided)
Built-in IR/RF remote control system
Manual switch (Up, Stop, Down)

Warranty

2 years



DETAILS

Canvas technology

Built on the same foundations as the Lumene UHD 4K canvas, the UHD 4K / 8K Platinum canvas is a 1.3 gain screen. The screen thus reproduces absorbed light more intensely, allowing every detail to be rendered with enhanced precision.

Motor Technology

Our motorized screens: Majestic HD, Showplace HD, Coliseum UHD 4K, and Coliseum UDH 4K / 8K Platinum are all equipped with our brand new Lumene Silent Motor. Entirely revamped, the motor offers a better user experience and ensures a longer lifespan.

INCLUDED :



IR remote control

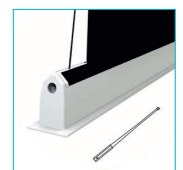

Lateral tension

OPTIONAL :



Wireless trigger
12V (433Mhz)



RF remote control

PACKAGING



Store horizontally

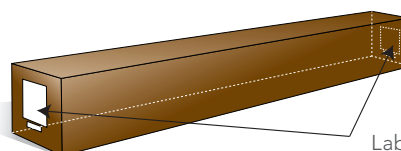

Labels

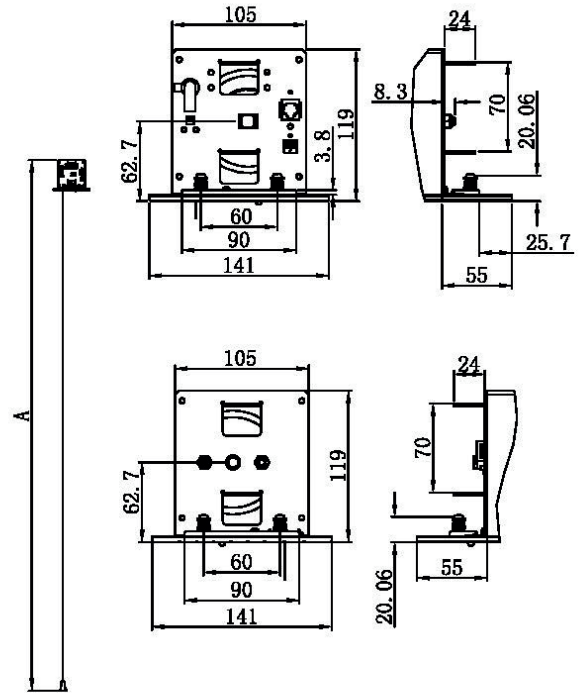
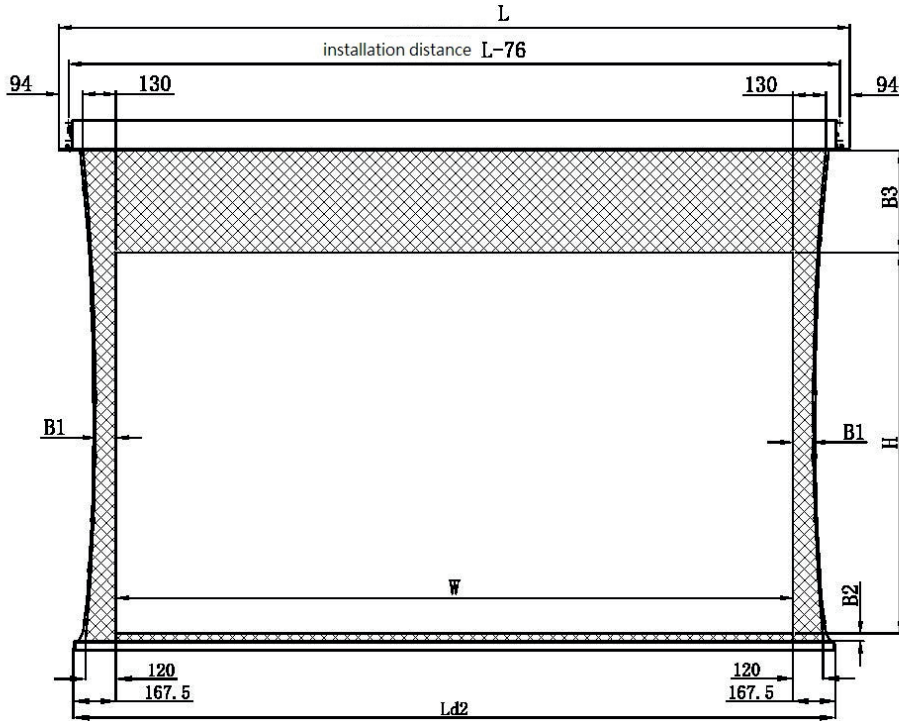

Ratio	Fabric	REF LUMENE	Image size W x H cm	Diagonal (inch)	Overall dimensions L x A x P mm	Ceiling cutting length L x W mm	Black borders & Extra-drop (mm)			Packaging dimensions (cm)	Net / gross weight (kg)	GEN code
							Sides (B1)	Bottom (B2)	Top (B3)			
16:9	LUMENE UHD4K-8K PLATINUM	SHOWPLACE UHD 4K-8K Platinum 200 TC	203 x 115	92	2480 x 141 x 119	2455 x 115 x (>122)	50	30	800	262 x 20 x 20	26,6 / 30,6	3700795162613
		SHOWPLACE UHD 4K-8K Platinum 240 TC	234 x 132	106	2794 x 141 x 119	2769 x 115 x (>122)	50	30	630	293 x 20 x 20	29,1 / 33,1	3700795162620
		SHOWPLACE UHD 4K-8K Platinum 270 TC	266 x 149	120	3104 x 141 x 119	3079 x 115 x (>122)	50	30	450	324 x 20 x 20	30,8 / 34,8	3700795162637
		SHOWPLACE UHD 4K-8K Platinum 300 TC	305 x 171	133	3320 x 141 x 119	3295 x 115 x (>122)	51	30	300	324 x 20 x 20	-	-